

DRAPER

EN

Original Instructions
Version 2 – May 2025

METAL KICKSTOOL

59246

Health and Safety Information

Important: Read all the Health and Safety instructions before attempting to use, maintain or repair this product. Failure to follow these instructions may result in injury or damage to the user or, the product.

- Read this manual in full before using this product and retain it for future use.



WARNING!

Risk of fall from the stool.

- **DO NOT** exceed the maximum weight capacity of **150kg**.
- **DO NOT** use if damaged. Before each use, visually inspect the stool to ensure it is not damaged and safe to use.
- Ensure the stool is suitable for the task to be carried out.
- Check that the castor wheels are correctly and securely fitted before use.
- **DO NOT** use on an unlevel or uneven surface.
- Ensure the base sits firmly on the floor before using.
- **DO NOT** use if the stool slips or slides when under load. The step should not move when weight is applied.
- Wear suitable non-slip footwear when using this stool.
- **DO NOT** overreach.
- **DO NOT** use the stool to access heavy items stored at height.
- **DO NOT** carry items which are heavy or difficult to handle when using this stool.



Assembling the Castor Wheels

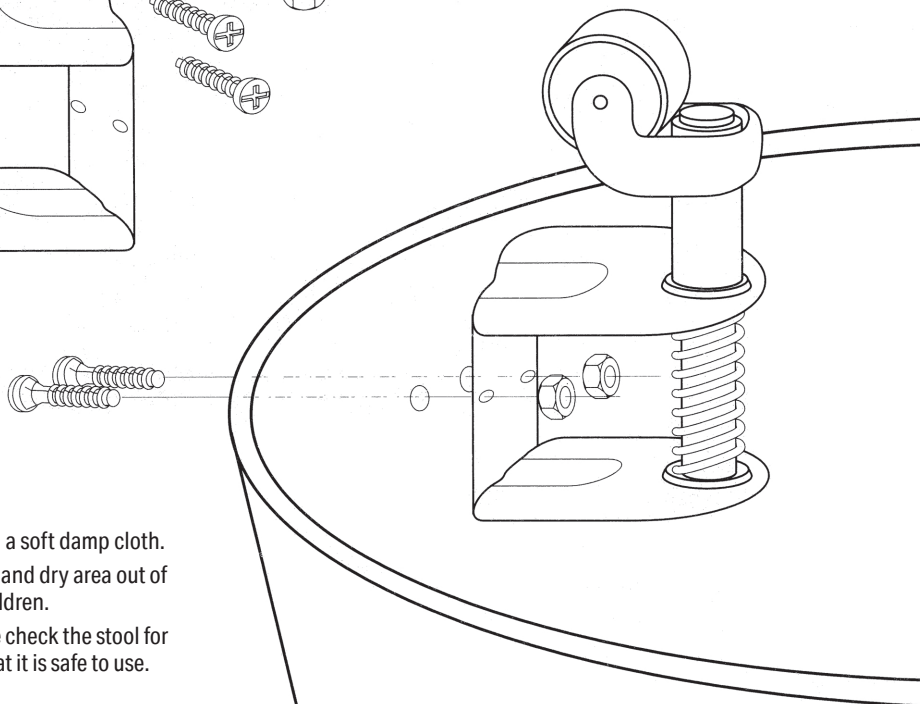
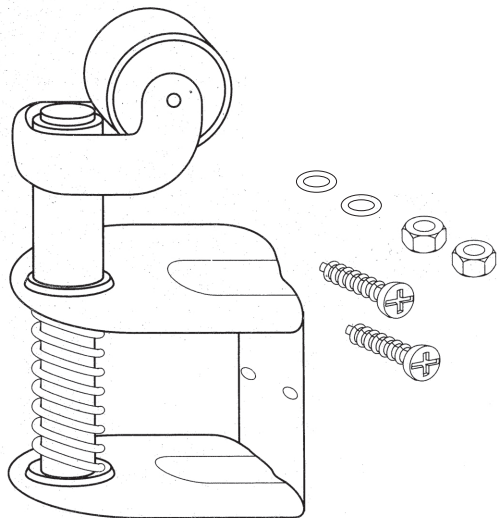

Maintenance

- Wipe clean with a soft damp cloth.
- Store in a clean and dry area out of the reach of children.
- Before each use check the stool for damage and that it is safe to use.

Warranty

12 months from date of purchase -
Visit [drapertools.com/warranty](https://www.drapertools.com/warranty)
for full details.

Contact Details

Draper Tools

Draper Tools Limited
Hursley Road
Chandler's Ford
Eastleigh
Hampshire
SO53 1YF
UK

Delta International

Delta International BV
Oude Graaf 8
6002 NL
Weert
Netherlands

Website: [drapertools.com](https://www.drapertools.com)

Email: sales@drapertools.com

Product Helpline: +44 (0) 23 8049 4344

Telephone Sales Desk: +44 (0) 23 8049 4333

General Enquiries: +44 (0) 23 8026 6355

Please contact the Draper Tools Product Helpline
for repair and servicing enquiries.